

## TRAFFIC ALERT

### Girder installation Logan Motorway / Wembley Road interchange, Berrinba

We are getting on with the job of upgrading your motorways. From Friday 11 January 2019, we will be installing girders for the new Wembley Road northbound bridge over the Logan Motorway. The bridge girder installation will be carried out in two stages, with associated traffic changes for the stages outlined below.

#### Stage 1 – Friday 11\*\* and Saturday 12 January 2019 (7pm until 8am)

The Logan Motorway at the Wembley Road interchange will be reduced to a single lane of travel in each direction on Friday 11\*\* and Saturday 12 January 2019, from 7pm to 8am, construction and weather permitting. See the map below for details. The Logan Motorway westbound on-ramp will be closed. A detour will be in place via Kingston Road (see detour map).

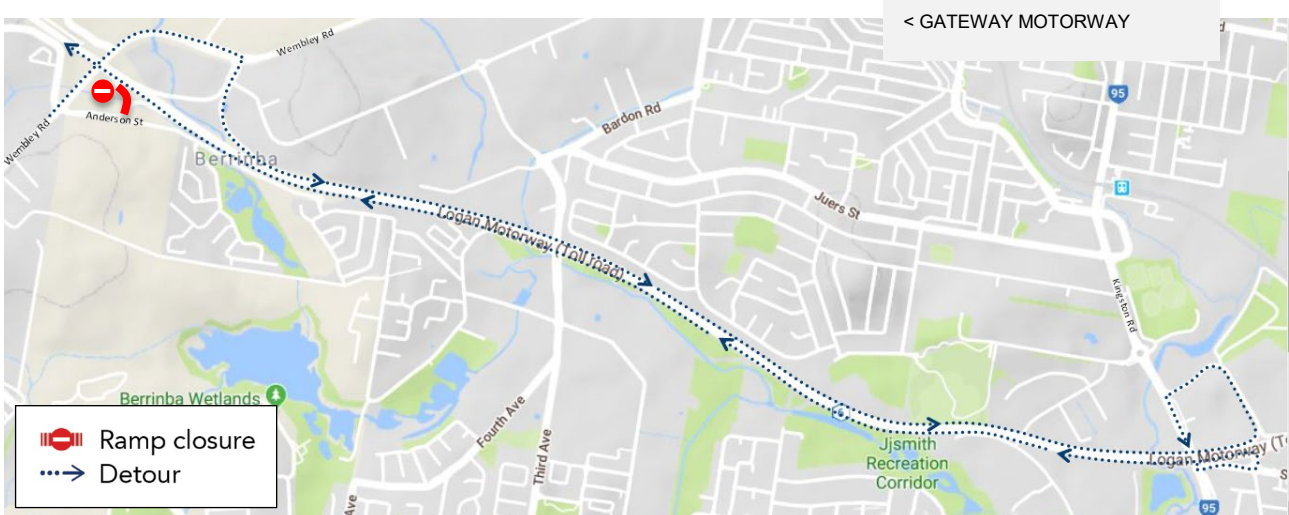
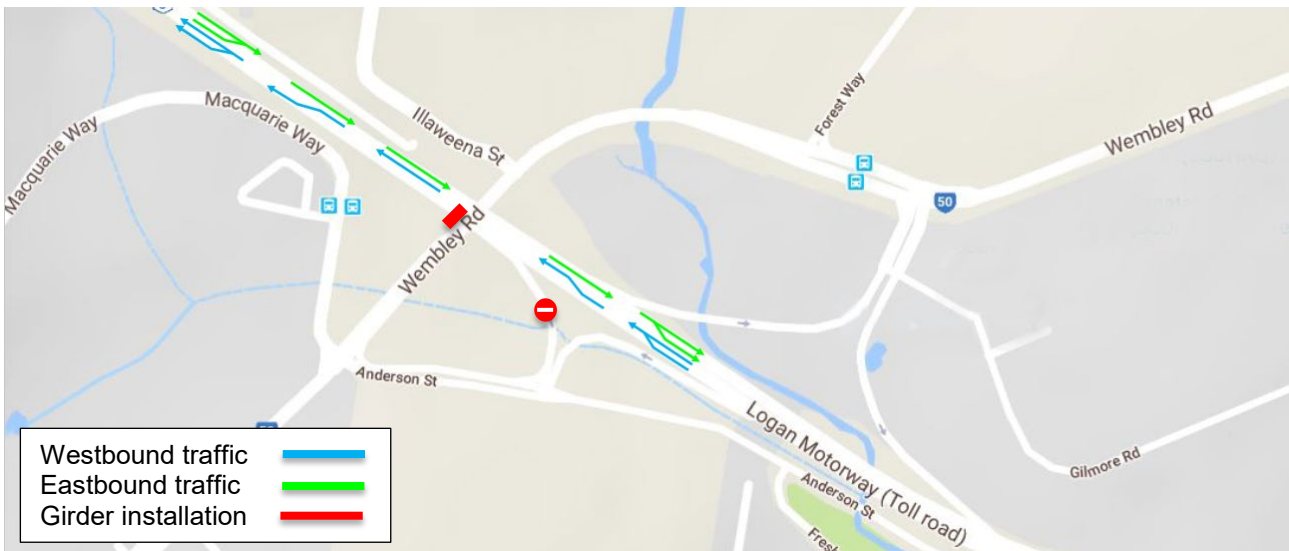

# LOGAN ENHANCEMENT PROJECT

## Stage 2 – Sunday 13 to Tuesday 15 January 2019 (7pm until 5am)

The Logan Motorway at the Wembley Road interchange will be reduced to a single lane of travel in each direction from Sunday 13 to Tuesday 15 January 2019, from 7pm to 5am, construction and weather permitting. The Gateway Motorway southbound will be closed with a detour via the Mt Lindesay Highway/Beaudesert Road interchange (see detour map). See the map below for details.

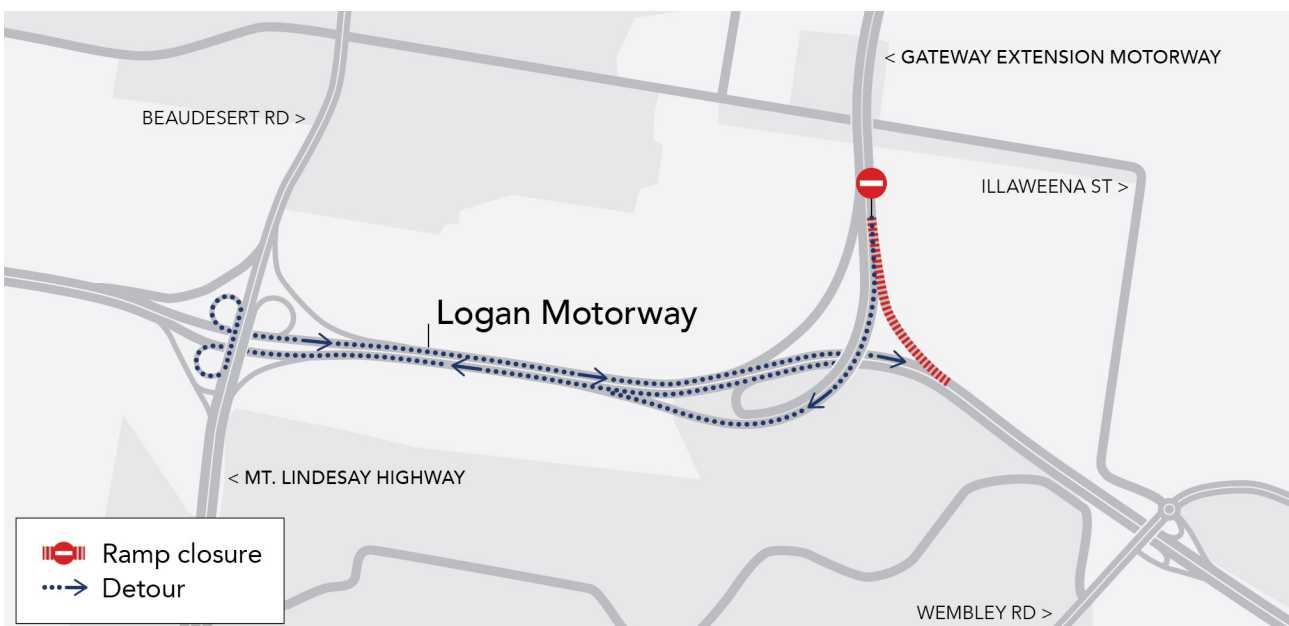
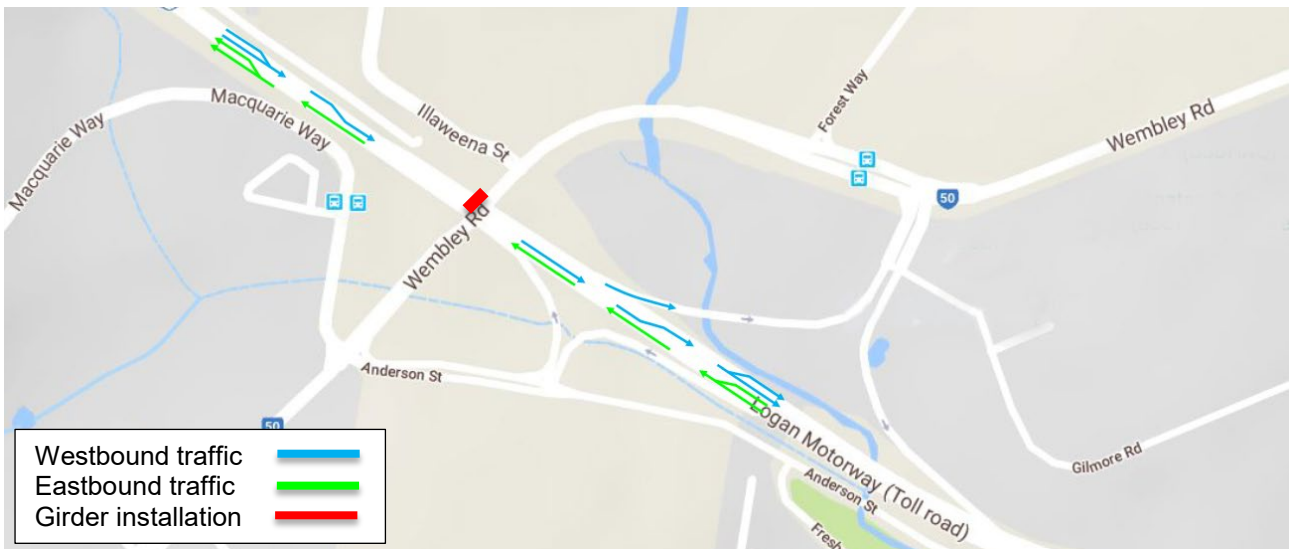

### What to expect during these works:

- increased activity around the work area including the presence of workers, vehicles and equipment
- road construction and resurfacing, road pavement profilers, compaction rollers, body trucks, line marking and use of hand tools, barrier relocation and installation of new signage
- traffic control and reduced speeds will be in place to ensure the safety of motorists and workers
- potential noise impacts from the use of machinery.

In the case of inclement weather or delays to the work, this work will be postponed to the next available shift. All works are scheduled to minimise impacts on the community and motorists. We thank you in advance for your patience during these works.

# LOGAN ENHANCEMENT PROJECT

## About the project

Transurban Queensland's \$512 million Logan Enhancement Project includes upgrading parts of the Logan and Gateway motorways, improving key congestion hot spots (Logan Motorway/Mt Lindesay Highway/Beaudesert Road interchange and the Wembley Road/Logan Motorway interchange) and constructing new south-facing ramps on the Gateway Motorway at Compton Road. Major construction is underway with the project anticipated to be completed in 2019.

## Keep updated about traffic changes

During construction of the Logan Enhancement Project we encourage you to plan ahead. For more information about upcoming traffic changes, view the [Road Users](#) page on the project website. Traffic information will also be posted on the [Queensland Traffic website](#) and provided to the 131940 call centre.

For more information about construction activities associated with the Logan Enhancement Project, please visit the project website (see below) or follow us on [Facebook](#).

## For more information

For more information about the project or to speak with a member of the Community Relations Team regarding these activities contact:

Phone: 1800 195 308 (toll free 24hours)\*  
Email: [contactus@loganenhancementproject.com.au](mailto:contactus@loganenhancementproject.com.au)  
Website: [www.loganenhancementproject.com.au](http://www.loganenhancementproject.com.au)  
Facebook: [facebook.com/LoganEP/](https://facebook.com/LoganEP/)

\*Free call anywhere in Australia. Call charges apply for mobile phones and pay phones. Check with your service provider for call costs.

\*\*8pm start time on Fridays.